

PRINT MANAGEMENT+

CENTRALIZED PRINT MANAGEMENT & DOCUMENT CAPTURE PLUS SEARCHABLE TEXT



Flexibility, agility, and digital productivity are key elements your business needs to thrive in today's business climate. These elements are critical factors for efficient print services for any successful IT organization.

YSoft SAFEQ Print Management Plus provides centralized print management and document capture with Scan Workflows and searchable text. Your team is armed with the tools needed to deliver cost savings, increased document security, and workflow productivity with the reporting and compliance necessary to prove value to company management.

Your success is backed by Y Soft support, project management and optional companion hardware to keep your print services agile, cost-effective and user friendly. Whether you choose to deploy on-premises, in a private data center or a mix of both, YSoft SAFEQ Print Management Plus is easily deployed to meet your needs.

KEY BENEFITS



VISIBILITY & CONTROL OF PRINT SERVICES

Do you know which groups are printing the most and at what cost? Which printers are most cost efficient for large B/W print jobs and which are more suitable for high quality color? With the reporting tools provided, you can make optimization decisions based on factual usage data.



IMPROVED SECURITY & DATA PRIVACY

Print services security begins with controlled access to the multifunction device (MFD). Only upon approved identify verification can a user access the MFD. And only authenticated users can release print jobs which means no print jobs are left in the output tray where they can be picked up by other employees or visitors ensuring data privacy.



FORECASTING AND REDUCING COSTS

When you have usage data at hand, you'll have an accurate forecast of print costs. You can also make decisions about the number of MFDs truly needed and assign access to them appropriately. Because print jobs are not released until the user authenticates at the MFD, consumable costs are reduced because print jobs sent but no longer needed are never printed.



AUTOMATED SCAN WORKFLOWS + SEARCHABLE TEXT

Simplified scan workflows increase productivity, accuracy, and consistency. With searchable text included, digital documents can be found through keyword search or meta data and edited. Digital documents suddenly become very valuable, reusable and productivity enhancers.

SAFEQ PRINT MANAGEMENT PLUS: KEY FEATURES

YSoft SAFEQ Print Management Plus is integrated within the user interface of the world's most popular MFDs. These key features deliver on our promise of increasing document security, reducing print service costs, and providing you visibility and control into your organization's print services activity. These features are intuitive and user friendly for end users and print administrators alike.

| FEATURE | BENEFITS AT-A-GLANCE |
|---|---|
| Authentication | <ul style="list-style-type: none">• Protects against unauthorized access to the MFD.• Documents remain secure until the user authenticates via card/mobile reader, PIN, or username/password.• Print jobs no longer needed are never printed.• Easily assign print, copy and scan rights to users or groups of users. Supports guest printing. |
| Print Roaming™ Client Based Print Roaming (CBPR) | <ul style="list-style-type: none">• Secure printing from any printer in the SAFEQ system without additional print drivers.• Scalable from one office to offices across multiple continents.• Optionally, with CBPR, reduce the number of print servers required by handling job processing on the user's workstation. |
| Rules-Based Engine | <ul style="list-style-type: none">• Apply from a library of common cost-reducing rules.• Create your own rules to enforce governance or sustainability by creating triggers.• User notifications sent when print rules have been applied.• Allocate print jobs by billing codes and sub billing codes at the MFD; assign billing codes to certain users.• Apply watermarks for document security upon defined triggers. |
| Reporting | <ul style="list-style-type: none">• Pre-defined or custom reports provide fact-based data and usage audits. Infinite custom reports can be created.• Dynamic reporting through exports to PowerBI or Tableau.• Generated on demand or scheduled and automatically routed.• Includes pre-defined templates for web reports and sustainability reports. |
| Mobile Print | <ul style="list-style-type: none">• Native iOS and Android smartphone printing & wireless printing.• Optional printing by file upload to email or web page.• Optional mobile apps for authentication and print job release. |
| Credit & Billing | <ul style="list-style-type: none">• Set and manage print quotas.• Create pay-to-print services.• Includes a desktop administration application. |
| Scan Workflows with Searchable Text | <ul style="list-style-type: none">• Automates paper-based tasks with a one-click scan workflow which simplifies scan capture, processing, and delivery to pre-defined locations.• Digital documents that are editable and keyword searchable.• Includes connectors to many 3rd party document repositories. |
| Extension Store | <ul style="list-style-type: none">• Customizes your use of SAFEQ and adds support for home/remote workers.• Choice of two customizable workflow integrations. |

HOW IT WORKS

1

User submits print job as normal. User authenticates at any printer for access to print/copy/scan; identity is verified against the corporate directory.

2

User chooses desired print job or all print jobs. If scanning, user chooses desired Scan Workflow.

3

Prints are processed; digital scan workflow attributes are applied.

4

Digital documents are delivered to pre-defined destinations automatically where they can be keyword/meta data searched and edited.

5

Reporting captures all authentication and print, copy, scan and fax activity.

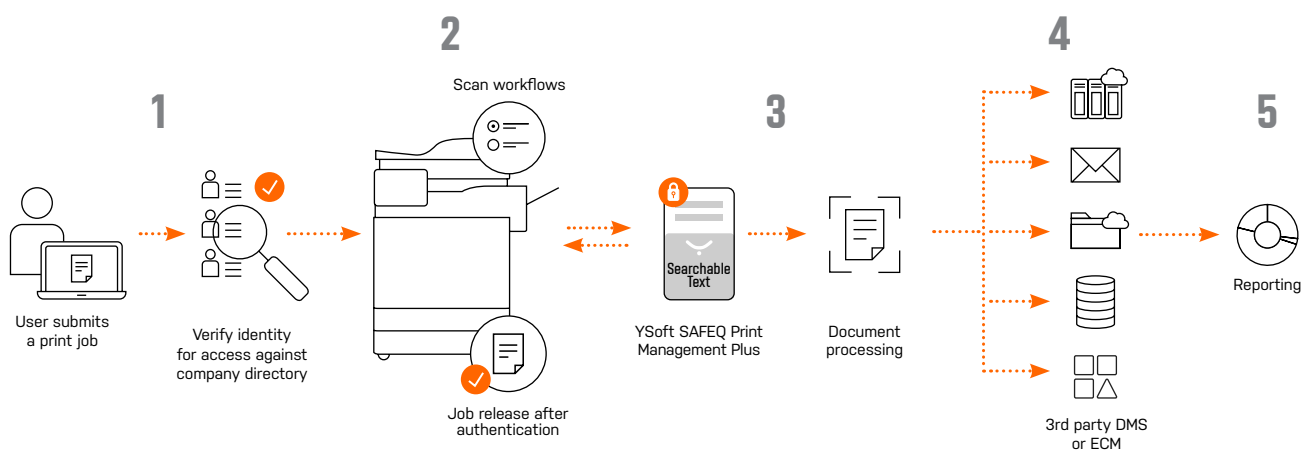

Figure 1. YSoft SAFEQ Print Management Plus – print and scan job workflows

THE POWER OF A DIGITAL ON-RAMP WITH SEARCHABLE TEXT

As Figure 1 shows, SAFEQ Automated Scan Workflows can output digital documents directly to pre-defined destinations: email, shared network folder, a cloud-based repository, or third-party applications such as Sharepoint, SAP, MicroFocus Content Manager, DocuWare or EPIC. This eliminates human error and increases the security of documents. It also reduces the complexity for users.

Pre-configured settings create a one-button process reducing time spent at the multifunction device (MFD). For administrators, pre-defined templates make creating task specific workflows for users or groups of users easy.

YSoft SAFEQ produces digital documents that are keyword searchable and editable.

THE Y SOFT DIFFERENCE

COMPANION HARDWARE

Y Soft is unique as a print management provider because we offer a comprehensive solution that enhances the user experience. Y Soft designs, manufactures and quality tests all companion hardware, so you are assured that software and hardware work well together and are supported by a single supplier. In fact, many competitive print management providers also use Y Soft companion hardware.

MOBILE/CARD READERS

A quick and convenient way for users to authenticate at the MFD is through an attached reader. The YSoft MFX Mobile reader combines a smartphone app with the reader for truly contactless authentication and print job release. Both the YSoft MFX Mobile and YSoft MFX readers also read traditional ID cards. Our free card reader service can verify compatibility with your existing access cards.

EXTERNAL TERMINALS

For printers and MFDs that do not support embedded software, Y Soft manufactures external terminals. These external terminals can also be used instead of embedded for a consistent user experience if you have a mixed brand print fleet.

GLOBAL SUPPORT

Renowned for our excellent, global support, YSoft SAFEQ offers a choice of direct support – where Y Soft personnel works with you on any issue, or indirect support – where your printer provider, a Y Soft certified reseller, provides first or second level support. Whether you choose direct or indirect support, we offer multiple packages to meet your needs.

GLOBAL OPERATIONAL SUPPORT (GOE) FRAMEWORK™

Depending upon the size and complexity of your print environment, the GOE Framework may be utilized. The GOE Framework is a proven set of processes and tools to ensure that your expected ROI is realized and that the project is delivered on time and on budget throughout the Discover, Design, Deploy stages along with ongoing support. Ask a Y Soft representative or certified Y Soft partner for more information.

© 2021 Y Soft Corporation a.s. All rights reserved. Y Soft, YSoft SAFEQ, Print Roaming and Global Operational Excellence are trademarks or registered trademarks of Y Soft Corporation in the European Union and individual countries. All other trademarks and/or registered trademarks are the property of their respective owners. Information in this document is subject to change without notice. P/N SFQ_PM+_DS_EN_11_2021